



H Line

NEMA

Three-Phase Induction Motors

*TEFC - Squirrel Cage Rotor
Low & Medium Voltage*

General Characteristics:

- Output: 135 up to 4000HP
- Voltages: up to 6600V
- Frequency: 60Hz
- Frames: 50 up to 104 (NEMA)
- Degree of protection: IP55 up to IPW65
- Mounting: Horizontal or vertical



**THREE-PHASE INDUCTION MOTORS
 HGF LINE - 460V - 60Hz - TEFC (IP55)
 INSULATION CLASS F - SERVICE FACTOR 1.15
 TEMPERATURE RISE 80°C AT SERVICE FACTOR 1.0**



Power		NEMA Frame	RPM	FULL LOAD AMPS	KVA /HP CODE	Tn Ft.lb	Ti/Tn	Tb/Tn	% OF FULL LOAD						INERTIA lb.Ft²	LRT sec.	Approx. WEIGHT lb
									EFFICIENCY			POWER FACTOR					
									50	75	100	50	75	100			
HP	KW																

2 POLE

275	200	5007	3562	299.1	G	405.7	1.50	2.20	93.00	94.20	94.60	0.87	0.89	0.91	66.44	15.0	2866
300	225	5008	3563	326.3	G	442.4	1.50	2.20	93.00	94.20	94.60	0.87	0.89	0.91	75.94	15.0	3086
350	250	5009	3563	379.5	G	516.1	1.50	2.20	93.50	94.50	94.90	0.87	0.89	0.91	83.05	15.0	3638
370	280	5009	3565	400.3	G	545.3	1.50	2.10	93.50	94.60	95.10	0.87	0.89	0.91	94.92	16.0	3858
400	315	5010	3565	428.1	G	589.5	1.50	2.10	93.60	94.60	95.10	0.88	0.90	0.92	106.78	16.0	4079
450	355	5010	3565	481.1	G	663.2	1.40	2.10	93.60	94.60	95.20	0.88	0.90	0.92	118.65	17.0	4299
500	400	5809	3565	545.8	G	736.9	1.40	2.10	94.00	94.80	95.30	0.87	0.89	0.90	130.51	17.0	5181
600	450	5810	3565	655.0	G	884.3	1.20	2.10	94.00	94.80	95.30	0.87	0.89	0.90	142.38	17.0	5512
700	500	5811	3570	754.2	G	1030.2	1.20	2.00	94.20	94.90	95.50	0.88	0.90	0.91	154.24	17.0	6063
750	560	5811	3570	808.0	G	1103.8	1.20	2.00	94.20	94.90	95.50	0.88	0.90	0.91	166.11	17.0	6504
800	630	6806	3570	861.9	G	1177.4	1.10	2.00	94.50	95.00	95.50	0.88	0.90	0.91	258.66	18.0	7496

4 POLE

275	200	5006	1782	312.9	G	810.8	1.40	2.10	93.00	94.30	94.60	0.82	0.85	0.87	83.05	18.0	2866
300	225	5007	1782	340.6	G	884.6	1.40	2.10	93.00	94.30	94.80	0.82	0.85	0.87	94.92	18.0	2976
350	250	5008	1783	397.3	G	1031.4	1.40	2.10	93.20	94.30	94.80	0.83	0.85	0.87	106.78	18.0	3086
370	280	5009	1783	419.2	G	1090.3	1.40	2.10	93.40	94.50	95.00	0.83	0.85	0.87	123.39	18.0	3527
400	315	5009	1785	447.1	G	1177.4	1.40	2.10	93.50	94.70	95.20	0.83	0.86	0.88	137.63	20.0	3638
450	355	5010	1785	502.4	G	1324.6	1.40	2.10	93.60	94.80	95.30	0.83	0.86	0.88	151.87	20.0	3792
500	400	5010	1786	550.8	G	1471.0	1.40	2.10	93.70	94.80	95.50	0.84	0.87	0.89	163.74	20.0	3968
600	450	5011	1788	660.3	G	1763.2	1.40	2.10	93.80	94.80	95.60	0.84	0.87	0.89	177.97	20.0	4189
700	500	5810	1788	768.7	G	2057.0	1.40	2.00	93.90	95.00	95.80	0.84	0.87	0.89	261.03	20.0	5952
750	560	5811	1790	821.9	G	2201.5	1.40	2.00	94.10	95.20	96.00	0.84	0.87	0.89	308.49	20.0	6393
800	630	6806	1790	874.9	F	2348.3	1.20	2.00	94.50	95.80	96.20	0.84	0.87	0.89	415.27	20.0	7606
900	710	6806	1790	984.2	F	2641.8	1.20	2.00	94.50	95.80	96.20	0.84	0.87	0.89	462.73	20.0	7826

6 POLE

250	180	5007	1182	286.2	F	1111.3	1.40	2.20	92.50	93.60	94.00	0.79	0.84	0.87	163.74	20.0	3086
275	200	5008	1183	314.2	F	1221.4	1.40	2.20	92.80	93.80	94.20	0.79	0.85	0.87	175.60	20.0	3307
300	225	5008	1183	342.0	F	1332.4	1.30	2.20	93.00	94.00	94.40	0.79	0.86	0.87	189.84	20.0	3593
350	250	5010	1185	394.1	F	1551.9	1.30	2.10	93.00	94.20	94.50	0.79	0.86	0.88	232.55	22.0	3968
370	280	5011	1185	416.1	F	1640.6	1.30	2.10	93.00	94.30	94.60	0.79	0.86	0.88	270.52	22.0	4189
400	315	5808	1185	462.3	G	1773.6	1.30	2.10	93.40	94.70	95.30	0.78	0.82	0.85	308.49	20.0	4850
450	355	5809	1188	513.6	G	1990.2	1.30	2.10	93.50	94.80	95.40	0.78	0.82	0.86	341.71	20.0	5291
500	400	5810	1188	569.4	G	2211.4	1.20	2.00	93.80	95.00	95.60	0.78	0.82	0.86	374.93	20.0	5952
600	450	5811	1190	681.9	G	2649.2	1.20	2.00	94.00	95.00	95.80	0.78	0.82	0.86	408.16	20.0	6393
700	500	6807	1190	795.5	G	3090.7	1.20	2.00	94.20	95.20	95.80	0.79	0.83	0.86	432.12	20.0	7496
750	560	6808	1190	852.3	G	3311.5	1.20	2.00	94.20	95.20	95.80	0.79	0.83	0.86	533.92	20.0	7937
800	630	8007	1190	897.8	G	3532.3	1.10	2.00	94.40	95.40	95.90	0.79	0.83	0.87	859.97	21.0	10803
900	710	8008	1190	1009.0	G	3973.8	1.10	2.00	94.50	95.50	96.00	0.79	0.83	0.87	959.17	21.0	11684

8 POLE

175	125	5007	885	213.7	F	1039.0	1.20	2.10	92.20	93.20	93.50	0.73	0.77	0.82	148.78	22.0	3086
200	140	5008	885	243.5	F	1187.4	1.20	2.10	92.50	93.40	93.80	0.73	0.77	0.82	154.25	22.0	3197
225	160	5008	885	270.0	F	1335.8	1.20	2.10	93.00	93.80	94.00	0.73	0.77	0.83	166.11	22.0	3417
250	180	5009	885	300.0	F	1484.2	1.20	2.10	93.00	93.80	94.00	0.73	0.80	0.83	192.22	22.0	3748
275	200	5009	890	330.0	F	1623.5	1.20	2.10	93.00	93.80	94.00	0.73	0.80	0.83	213.57	22.0	3858
300	225	5808	890	362.1	G	1771.1	1.20	2.10	93.00	94.30	94.60	0.73	0.80	0.82	303.51	20.0	5071
350	250	5809	890	416.5	G	2066.3	1.20	2.00	93.20	94.40	94.80	0.73	0.80	0.83	336.97	20.0	5291
370	280	5809	890	439.8	G	2184.3	1.10	2.00	93.40	94.60	94.90	0.74	0.80	0.83	377.54	20.0	5732
400	315	5810	890	474.0	F	2361.5	1.10	2.00	93.50	94.70	95.20	0.74	0.80	0.83	424.77	20.0	6173
450	355	5811	890	531.6	F	2656.6	1.10	2.00	93.70	94.80	95.50	0.75	0.81	0.83	478.63	20.0	6614
500	400	6806	890	584.2	F	2951.8	1.10	1.90	93.80	94.80	95.40	0.75	0.82	0.84	742.04	20.0	7826
600	450	6807	890	700.3	F	3542.2	1.10	1.90	94.00	95.00	95.50	0.75	0.82	0.84	825.80	20.0	8377
700	500	6808	890	817.0	F	4132.5	1.10	1.90	94.00	95.00	95.50	0.75	0.82	0.84	896.99	20.0	8708
750	560	8007	890	872.6	F	4427.7	1.00	1.90	94.30	95.40	95.80	0.76	0.83	0.84	1359.25	20.0	11023
800	630	8008	890	918.9	F	4722.9	1.00	1.90	94.40	95.50	95.90	0.77	0.84	0.85	1633.81	20.0	11684
900	710	8009	890	1032.7	F	5313.3	1.00	1.90	94.50	95.60	96.00	0.77	0.84	0.85	1793.99	20.0	12125

NOTE: The values shown are subject to change without prior notice.

THREE-PHASE INDUCTION MOTORS
HGF LINE - 460V - 60Hz - TEFC (IP55)
INSULATION CLASS F - SERVICE FACTOR 1.15
TEMPERATURE RISE 80°C AT SERVICE FACTOR 1.0



Power		NEMA Frame	RPM	FULL LOAD AMPS	KVA /HP CODE	Tn Ft.lb	Ti/Tn	Tb/Tn	% OF FULL LOAD						INERTIA lb.Ft²	LRT sec.	Approx. WEIGHT lb
									EFFICIENCY			POWER FACTOR					
HP	kW								50	75	100	50	75	100			

10 POLE

175	200	5009	708	246.8	H	1298.7	1.20	2.10	92.50	93.40	93.50	0.55	0.67	0.71	220.69	20.0	3638
200	140	5010	708	282.1	H	1484.2	1.20	2.10	92.50	93.40	93.50	0.55	0.67	0.71	246.79	20.0	3858
225	160	5808	710	314.3	H	1665.1	1.20	2.10	93.20	94.20	94.40	0.55	0.67	0.71	363.07	20.0	4740
250	180	5809	710	349.2	H	1850.1	1.20	2.10	93.20	94.20	94.40	0.55	0.67	0.71	403.41	20.0	5071
275	200	5809	710	384.2	H	2035.1	1.20	2.10	93.20	94.20	94.40	0.55	0.67	0.71	450.87	20.0	5291
300	225	5810	710	419.1	H	2220.1	1.20	2.10	93.20	94.20	94.40	0.55	0.67	0.71	517.31	20.0	5842
350	250	5811	710	488.9	H	2590.1	1.20	2.10	93.20	94.20	94.40	0.55	0.67	0.71	564.77	20.0	6504
370	280	6806	712	482.2	G	2730.4	0.80	2.00	94.20	95.30	95.80	0.62	0.70	0.75	742.75	18.0	7826
400	315	6807	712	521.3	G	2951.8	0.80	2.00	94.20	95.30	95.80	0.62	0.70	0.75	806.82	18.0	8488
450	355	6808	712	586.4	G	3320.8	0.80	2.00	94.20	95.30	95.80	0.62	0.70	0.75	920.72	18.0	9039
500	400	6809	712	651.6	G	3689.8	0.80	2.00	94.20	95.30	95.80	0.62	0.70	0.75	1034.63	18.0	10362
600	450	6810	712	781.9	G	4427.7	0.80	2.00	94.20	95.30	95.80	0.62	0.70	0.75	1148.53	18.0	10913
700	500	8006	712	910.3	H	5165.7	0.80	1.90	94.80	95.80	96.00	0.62	0.70	0.75	1494.99	15.0	11023
750	560	8007	712	975.3	H	5534.7	0.80	1.90	94.80	95.80	96.00	0.62	0.70	0.75	1741.78	15.0	11795
800	630	8008	712	1040.3	H	5903.6	0.80	1.90	94.80	95.80	96.00	0.62	0.70	0.75	2071.63	15.0	13007

12 POLE

175	125	5809	594	235.6	G	1548.0	0.90	2.00	92.50	93.00	94.00	0.53	0.66	0.74	379.68	20.0	4740
200	140	5809	594	268.6	G	1769.1	0.90	2.00	92.50	93.80	94.20	0.53	0.66	0.74	427.14	20.0	5071
225	160	5810	594	301.6	G	1990.2	0.90	2.00	93.00	94.00	94.40	0.53	0.66	0.74	474.60	20.0	5291
250	180	5811	594	334.7	G	2211.4	0.90	2.00	93.20	94.40	94.50	0.53	0.66	0.74	522.06	20.0	5842
275	200	5812	594	367.8	G	2432.5	0.90	2.00	93.20	94.30	94.60	0.53	0.66	0.74	569.52	20.0	6504
300	225	6807	594	383.2	G	2653.7	0.80	1.90	93.50	94.70	95.20	0.61	0.72	0.77	806.82	18.0	8488
350	250	6808	594	446.6	G	3095.9	0.80	1.90	93.80	94.80	95.30	0.61	0.72	0.77	920.72	18.0	9039
370	280	6809	594	471.1	G	3272.8	0.80	1.90	94.00	95.10	95.50	0.61	0.72	0.77	1034.63	18.0	10362
400	315	6810	594	507.7	G	3538.2	0.80	1.90	94.20	95.30	95.80	0.61	0.72	0.77	1148.53	18.0	10913
450	355	8006	594	574.2	G	3980.5	0.80	1.90	94.10	95.10	95.30	0.61	0.73	0.77	1494.99	18.0	11023
500	400	8007	594	636.6	G	4422.8	0.80	1.90	94.30	95.30	95.50	0.61	0.73	0.77	1741.78	18.0	11795
600	450	8008	594	763.2	G	5307.3	0.80	1.90	94.50	95.50	95.60	0.61	0.73	0.77	2071.63	18.0	13007
700	500	8809	593	918.9	G	6202.3	0.80	2.00	94.10	95.00	95.10	0.58	0.69	0.75	2918.79	21.0	18519
750	560	8810	593	982.5	G	6645.3	0.80	2.00	94.10	95.10	95.30	0.58	0.69	0.75	3440.85	21.0	19841

NOTE: The values shown are subject to change without prior notice.

**THREE-PHASE INDUCTION MOTORS
HGF LINE - 575V - 60Hz - TEFC (IP55)
INSULATION CLASS F - SERVICE FACTOR 1.15
TEMPERATURE RISE 80°C AT SERVICE FACTOR 1.0**



Power		NEMA Frame	RPM	FULL LOAD AMPS	KVA /HP CODE	Tn Ft.lb	Ti/Tn	Tb/Tn	% OF FULL LOAD						INERTIA lb.Ft²	LRT sec.	Approx. WEIGHT lb
									EFFICIENCY			POWER FACTOR					
HP	KW								50	75	100	50	75	100			

2 POLE

275	200	5007	3562	239.3	G	405.7	1.50	2.20	93.00	94.20	94.60	0.87	0.89	0.91	66.44	15.0	2866
300	225	5008	3563	261.0	G	442.4	1.50	2.20	93.00	94.20	94.60	0.87	0.89	0.91	75.94	15.0	3086
350	250	5009	3563	303.6	G	516.1	1.50	2.20	93.50	94.50	94.90	0.87	0.89	0.91	83.05	15.0	3638
370	280	5009	3565	320.2	G	545.3	1.50	2.10	93.50	94.60	95.10	0.87	0.89	0.91	94.92	16.0	3858
400	315	5010	3565	342.5	G	589.5	1.50	2.10	93.60	94.60	95.10	0.88	0.90	0.92	106.78	16.0	4079
450	355	5010	3565	384.9	G	663.2	1.40	2.10	93.60	94.60	95.20	0.88	0.90	0.92	118.65	17.0	4299
500	400	5809	3565	436.6	G	736.9	1.40	2.10	94.00	94.80	95.30	0.87	0.89	0.90	130.51	17.0	5181
600	450	5810	3565	524.0	G	884.3	1.20	2.10	94.00	94.80	95.30	0.87	0.89	0.90	142.38	17.0	5512
700	500	5811	3570	603.4	G	1030.2	1.20	2.00	94.20	94.90	95.50	0.88	0.90	0.91	154.24	17.0	6063
750	560	5811	3570	646.4	G	1103.8	1.20	2.00	94.20	94.90	95.50	0.88	0.90	0.91	166.11	17.0	6504
800	630	6806	3570	689.5	G	1177.4	1.10	2.00	94.50	95.00	95.50	0.88	0.90	0.91	258.66	18.0	7496

4 POLE

275	200	5006	1782	250.3	G	810.8	1.40	2.10	93.00	94.30	94.60	0.82	0.85	0.87	83.05	18.0	2866
300	225	5007	1782	272.5	G	884.6	1.40	2.10	93.00	94.30	94.80	0.82	0.85	0.87	94.92	18.0	2976
350	250	5008	1783	317.8	G	1031.4	1.40	2.10	93.20	94.30	94.80	0.83	0.85	0.87	106.78	18.0	3086
370	280	5009	1783	335.4	G	1090.3	1.40	2.10	93.40	94.50	95.00	0.83	0.85	0.87	123.40	18.0	3527
400	315	5009	1785	357.7	G	1177.4	1.40	2.10	93.50	94.70	95.20	0.83	0.86	0.88	137.63	20.0	3638
450	355	5010	1785	401.9	G	1324.6	1.40	2.10	93.60	94.80	95.30	0.83	0.86	0.88	151.87	20.0	3792
500	400	5010	1786	440.6	G	1471.0	1.40	2.10	93.70	94.80	95.50	0.84	0.87	0.89	163.74	20.0	3968
600	450	5011	1788	528.2	G	1763.2	1.40	2.10	93.80	94.80	95.60	0.84	0.87	0.89	177.97	20.0	4189
700	500	5810	1788	615.0	G	2057.0	1.40	2.00	93.90	95.00	95.80	0.84	0.87	0.89	261.03	20.0	5952
750	560	5811	1790	657.5	G	2201.5	1.40	2.00	94.10	95.20	96.00	0.84	0.87	0.89	308.49	20.0	6393
800	630	6806	1790	699.9	F	2348.3	1.20	2.00	94.50	95.80	96.20	0.84	0.87	0.89	415.27	20.0	7606
900	710	6806	1790	787.4	F	2641.8	1.20	2.00	94.50	95.80	96.20	0.84	0.87	0.89	462.73	20.0	7826

6 POLE

250	180	5007	1182	229.0	F	1111.3	1.40	2.20	92.50	93.60	94.00	0.79	0.84	0.87	163.74	20.0	3086
275	200	5008	1183	251.4	F	1221.4	1.40	2.20	92.80	93.80	94.20	0.79	0.85	0.87	175.60	20.0	3307
300	225	5008	1183	273.6	F	1332.4	1.30	2.20	93.00	94.00	94.40	0.79	0.86	0.87	189.84	20.0	3593
350	250	5010	1185	315.3	F	1551.9	1.30	2.10	93.00	94.20	94.50	0.79	0.86	0.88	232.55	22.0	3968
370	280	5011	1185	332.9	F	1640.6	1.30	2.10	93.00	94.30	94.60	0.79	0.86	0.88	270.52	22.0	4189
400	315	5808	1185	369.8	G	1773.6	1.30	2.10	93.40	94.70	95.30	0.78	0.82	0.85	308.49	20.0	4850
450	355	5809	1188	410.9	G	1990.2	1.30	2.10	93.50	94.80	95.40	0.78	0.82	0.86	341.71	20.0	5291
500	400	5810	1188	455.5	G	2211.4	1.20	2.00	93.80	95.00	95.60	0.78	0.82	0.86	374.93	20.0	5952
600	450	5811	1190	545.5	G	2649.2	1.20	2.00	94.00	95.00	95.80	0.78	0.82	0.86	408.16	20.0	6393
700	500	6807	1190	636.4	G	3090.7	1.20	2.00	94.20	95.20	95.80	0.79	0.83	0.86	432.12	20.0	7496
750	560	6808	1190	681.8	G	3311.5	1.20	2.00	94.20	95.20	95.80	0.79	0.83	0.86	533.92	20.0	7937
800	630	8007	1190	718.2	G	3532.3	1.10	2.00	94.40	95.40	95.90	0.79	0.83	0.87	859.97	21.0	10803
900	710	8008	1190	807.2	G	3973.8	1.10	2.00	94.50	95.50	96.00	0.79	0.83	0.87	959.17	21.0	11684

8 POLE

175	125	5007	885	171.0	F	1039.0	1.20	2.10	92.20	93.20	93.50	0.73	0.77	0.82	148.79	22.0	3086
200	140	5008	885	194.8	F	1187.4	1.20	2.10	92.50	93.40	93.80	0.73	0.77	0.82	154.24	22.0	3197
225	160	5008	885	216.0	F	1335.8	1.20	2.10	93.00	93.80	94.00	0.73	0.77	0.83	166.11	22.0	3417
250	180	5009	885	240.0	F	1484.2	1.20	2.10	93.00	93.80	94.00	0.73	0.80	0.83	192.21	22.0	3748
275	200	5009	890	264.0	F	1623.5	1.20	2.10	93.00	93.80	94.00	0.73	0.80	0.83	213.57	22.0	3858
300	225	5808	890	289.7	G	1771.1	1.20	2.10	93.00	94.30	94.60	0.73	0.80	0.82	303.51	20.0	5071
350	250	5809	890	333.2	G	2066.3	1.20	2.00	93.20	94.40	94.80	0.73	0.80	0.83	336.97	20.0	5291
370	280	5809	890	351.8	G	2184.3	1.10	2.00	93.40	94.60	94.90	0.74	0.80	0.83	377.54	20.0	5732
400	315	5810	890	379.2	F	2361.5	1.10	2.00	93.50	94.70	95.20	0.74	0.80	0.83	424.77	20.0	6173
450	355	5811	890	425.3	F	2656.6	1.10	2.00	93.70	94.80	95.50	0.75	0.81	0.83	478.63	20.0	6614
500	400	6806	890	467.4	F	2951.8	1.10	1.90	93.80	94.80	95.40	0.75	0.82	0.84	742.04	20.0	7826
600	450	6807	890	560.2	F	3542.2	1.10	1.90	94.00	95.00	95.50	0.75	0.82	0.84	825.80	20.0	8377
700	500	6808	890	653.6	F	4132.5	1.10	1.90	94.00	95.00	95.50	0.75	0.82	0.84	896.99	20.0	8708
750	560	8007	890	698.1	F	4427.7	1.00	1.90	94.30	95.40	95.80	0.76	0.83	0.84	1359.25	20.0	11023
800	630	8008	890	735.1	F	4722.9	1.00	1.90	94.40	95.50	95.90	0.77	0.84	0.85	1633.81	20.0	11684
900	710	8009	890	826.2	F	5313.3	1.00	1.90	94.50	95.60	96.00	0.77	0.84	0.85	1793.99	20.0	12125

NOTE: The values shown are subject to change without prior notice.

THREE-PHASE INDUCTION MOTORS
HGF LINE - 575V - 60Hz - TEFC (IP55)
INSULATION CLASS F - SERVICE FACTOR 1.15
TEMPERATURE RISE 80°C AT SERVICE FACTOR 1.0



Power		NEMA Frame	RPM	FULL LOAD AMPS	KVA /HP CODE	Tn Ft.lb	Ti/Tn	Tb/Tn	% OF FULL LOAD						INERTIA lb.Ft²	LRT sec.	Approx. WEIGHT lb
									EFFICIENCY			POWER FACTOR					
HP	KW								50	75	100	50	75	100			

10 POLE

175	125	5009	708	197.4	H	1298.7	1.20	2.10	92.50	93.40	93.50	0.55	0.67	0.71	220.69	20.0	3638
200	140	5010	708	225.7	H	1484.2	1.20	2.10	92.50	93.40	93.50	0.55	0.67	0.71	246.79	20.0	3858
225	160	5808	710	251.4	H	1665.1	1.20	2.10	93.20	94.20	94.40	0.55	0.67	0.71	363.07	20.0	4740
250	180	5809	710	279.4	H	1850.1	1.20	2.10	93.20	94.20	94.40	0.55	0.67	0.71	403.41	20.0	5071
275	200	5809	710	307.4	H	2035.1	1.20	2.10	93.20	94.20	94.40	0.55	0.67	0.71	450.87	20.0	5291
300	225	5810	710	335.3	H	2220.1	1.20	2.10	93.20	94.20	94.40	0.55	0.67	0.71	517.31	20.0	5842
350	250	5811	710	391.1	H	2590.1	1.20	2.10	93.20	94.20	94.40	0.55	0.67	0.71	564.77	20.0	6504
370	280	6806	712	385.8	G	2730.4	0.80	2.00	94.20	95.30	95.80	0.62	0.70	0.75	742.75	18.0	7826
400	315	6807	712	417.0	G	2951.8	0.80	2.00	94.20	95.30	95.80	0.62	0.70	0.75	806.82	18.0	8488
450	355	6808	712	469.1	G	3320.8	0.80	2.00	94.20	95.30	95.80	0.62	0.70	0.75	920.72	18.0	9039
500	400	6809	712	521.3	G	3689.8	0.80	2.00	94.20	95.30	95.80	0.62	0.70	0.75	1034.63	18.0	10362
600	450	6810	712	625.5	G	4427.7	0.80	2.00	94.20	95.30	95.80	0.62	0.70	0.75	1148.53	18.0	10913
700	500	8006	712	728.2	H	5165.7	0.80	1.90	94.80	95.80	96.00	0.62	0.70	0.75	1494.99	15.0	11023
750	560	8007	712	780.2	H	5534.7	0.80	1.90	94.80	95.80	96.00	0.62	0.70	0.75	1741.78	15.0	11795
800	630	8008	712	832.2	H	5903.6	0.80	1.90	94.80	95.80	96.00	0.62	0.70	0.75	2071.63	15.0	13007

12 POLE

175	125	5809	594	188.5	G	1548.0	0.90	2.00	92.50	93.00	94.00	0.53	0.66	0.74	379.68	20.0	4740
200	140	5809	594	214.9	G	1769.1	0.90	2.00	92.50	93.80	94.20	0.53	0.66	0.74	427.14	20.0	5071
225	160	5810	594	241.3	G	1990.2	0.90	2.00	93.00	94.00	94.40	0.53	0.66	0.74	474.60	20.0	5291
250	180	5811	594	267.8	G	2211.4	0.90	2.00	93.20	94.40	94.50	0.53	0.66	0.74	522.06	20.0	5842
275	200	5812	594	294.2	G	2432.5	0.90	2.00	93.20	94.30	94.60	0.53	0.66	0.74	569.52	20.0	6504
300	225	6807	594	306.6	G	2653.7	0.80	1.90	93.50	94.70	95.20	0.61	0.72	0.77	806.82	18.0	8488
350	250	6808	594	357.3	G	3095.9	0.80	1.90	93.80	94.80	95.30	0.61	0.72	0.77	920.72	18.0	9039
370	280	6809	594	376.9	G	3272.8	0.80	1.90	94.00	95.10	95.50	0.61	0.72	0.77	1034.63	18.0	10362
400	315	6810	594	406.2	G	3538.2	0.80	1.90	94.20	95.30	95.80	0.61	0.72	0.77	1148.53	18.0	10913
450	355	8006	594	459.4	G	3980.5	0.80	1.90	94.10	95.10	95.30	0.61	0.73	0.77	1494.99	18.0	11023
500	400	8007	594	509.3	G	4422.8	0.80	1.90	94.30	95.30	95.50	0.61	0.73	0.77	1741.78	18.0	11795
600	450	8008	594	610.6	G	5307.3	0.80	1.90	94.50	95.50	95.60	0.61	0.73	0.77	2071.63	18.0	13007
700	500	8809	593	735.1	G	6202.3	0.80	2.00	94.10	95.00	95.10	0.58	0.69	0.75	2918.79	21.0	18519
750	560	8810	593	786.0	G	6645.3	0.80	2.00	94.10	95.10	95.30	0.58	0.69	0.75	3440.85	21.0	19841

NOTE: The values shown are subject to change without prior notice.

THREE-PHASE INDUCTION MOTORS
HGF LINE - 2300V - 60Hz - TEFC (IP55)
INSULATION CLASS F - SERVICE FACTOR 1.15
TEMPERATURE RISE 80°C AT SERVICE FACTOR 1.0



Power		NEMA Frame	RPM	FULL LOAD AMPS	KVA /HP CODE	Tn Ft.lb	Ti/Tn	Tb/Tn	% OF FULL LOAD						INERTIA lb.Ft²	LRT sec.	Approx. WEIGHT lb
									EFFICIENCY			POWER FACTOR					
HP	kW								50	75	100	50	75	100			

6 POLE

135	100	5006	1180	33.3	F	601.1	1.30	2.00	91.30	92.10	92.50	0.68	0.76	0.82	113.90	20.0	2646
150	112	5006	1180	37.0	F	667.9	1.30	2.00	91.50	92.30	92.60	0.68	0.76	0.82	123.40	20.0	2756
175	125	5007	1180	43.1	F	779.2	1.30	2.00	91.60	92.50	92.80	0.68	0.72	0.82	140.01	20.0	2866
200	140	5007	1180	49.1	F	890.6	1.30	2.00	91.80	92.60	93.00	0.69	0.76	0.82	156.62	20.0	2976
225	160	5008	1180	55.1	F	1001.9	1.30	2.00	92.00	92.80	93.20	0.69	0.77	0.82	158.99	20.0	3086
250	180	5009	1180	60.3	F	1113.2	1.30	2.00	92.30	93.00	93.50	0.70	0.77	0.83	187.47	20.0	3417
275	200	5009	1180	66.1	F	1224.5	1.30	2.00	92.60	93.10	93.80	0.71	0.78	0.83	201.70	20.0	3593
300	225	5010	1180	72.0	F	1335.8	1.30	2.00	92.80	93.40	94.00	0.72	0.78	0.83	223.06	20.0	3748
350	250	5011	1181	83.7	F	1557.1	1.30	2.00	93.00	93.50	94.30	0.72	0.78	0.83	246.79	20.0	3968
370	280	5011	1181	87.3	F	1646.1	1.30	2.00	93.00	93.80	94.50	0.73	0.79	0.84	265.78	20.0	4189
400	315	5810	1181	94.1	F	1779.6	1.20	2.00	93.20	94.00	94.80	0.73	0.79	0.84	270.52	20.0	5512
450	355	5811	1182	105.6	F	2000.3	1.20	2.00	93.40	94.20	95.00	0.73	0.79	0.84	301.37	20.0	5842
500	400	5812	1182	117.1	F	2222.6	1.20	2.00	93.60	94.40	95.20	0.73	0.79	0.84	344.08	20.0	6173
600	450	5812	1182	140.4	F	2667.1	1.20	2.00	93.70	94.50	95.30	0.74	0.80	0.84	379.68	20.0	6504
700	500	6807	1185	163.4	F	3103.8	1.20	2.00	93.80	94.60	95.50	0.74	0.80	0.84	412.90	20.0	7165
750	560	6808	1186	174.7	F	3322.7	1.20	2.00	94.00	94.80	95.70	0.74	0.80	0.84	462.73	20.0	7716
800	630	6809	1185	184.0	F	3547.2	1.10	1.90	94.00	94.90	95.80	0.74	0.81	0.85	505.45	20.0	8157
900	710	6810	1185	206.5	F	3990.6	1.10	1.90	94.10	95.00	96.00	0.74	0.81	0.85	567.15	20.0	8598
1000	800	8009	1187	226.6	F	4426.5	1.00	1.90	94.20	95.10	96.10	0.75	0.82	0.86	963.44	20.0	10251
1250	900	8010	1187	282.9	F	5533.1	1.00	1.90	94.40	95.20	96.20	0.76	0.82	0.86	1074.97	20.0	11354
1350	1000	8010	1187	305.3	F	5975.7	1.00	1.90	94.50	95.30	96.30	0.76	0.83	0.86	1167.51	20.0	11795
1500	1120	8806	1188	338.8	F	6634.1	0.90	1.80	94.70	95.40	96.40	0.76	0.83	0.86	1661.10	21.0	12236
1750	1250	8807	1188	394.9	F	7739.8	0.90	1.80	94.80	95.50	96.50	0.77	0.83	0.86	2147.56	21.0	13117
2000	1400	8808	1188	451.3	F	8845.5	0.90	1.80	95.00	95.50	96.50	0.77	0.83	0.86	2354.02	21.0	15212
2250	1600	9606	1190	501.3	F	9934.5	0.80	1.80	95.00	95.60	96.60	0.78	0.84	0.87	2728.95	21.0	15873
2500	1800	9607	1190	557.0	F	11038.3	0.80	1.80	95.10	95.70	96.60	0.78	0.84	0.87	3571.36	21.0	18629
2750	2000	9608	1190	613.4	F	12142.1	0.80	1.80	95.20	95.80	96.50	0.78	0.84	0.87	3875.11	21.0	19841
3000	2250	10408	1190	669.2	G	13246.0	0.80	1.80	95.20	95.80	96.50	0.78	0.84	0.87	4983.30	21.0	21605

8 POLE

135	100	5006	886	35.1	F	800.6	1.20	2.00	91.30	92.00	92.30	0.66	0.74	0.78	149.499	20.0	2976
150	112	5007	886	38.9	F	889.5	1.20	2.00	91.50	92.10	92.50	0.66	0.74	0.78	152.821	20.0	3086
175	125	5008	886	44.6	F	1037.8	1.20	2.00	91.70	92.30	93.00	0.67	0.74	0.79	168.008	20.0	3197
200	140	5009	887	50.9	F	1184.7	1.20	2.00	91.90	92.50	93.20	0.67	0.75	0.79	204.078	20.0	3417
225	160	5009	887	57.0	F	1332.8	1.20	2.00	92.00	92.60	93.50	0.67	0.75	0.79	246.792	20.0	3638
250	180	5010	888	62.5	F	1479.2	1.20	2.00	92.20	92.80	93.70	0.67	0.76	0.80	256.284	20.0	3858
275	200	5011	888	68.6	F	1627.2	1.20	2.00	92.30	92.90	93.90	0.68	0.76	0.80	266.251	20.0	4079
300	225	5807	889	73.7	F	1773.1	1.10	2.00	92.50	93.00	94.10	0.68	0.76	0.81	341.712	20.0	5071
350	250	5808	889	85.8	F	2068.6	1.10	2.00	92.60	93.20	94.30	0.70	0.76	0.81	387.511	20.0	5291
370	280	5809	890	89.4	F	2184.3	1.10	2.00	92.80	93.30	94.50	0.70	0.78	0.82	433.073	20.0	5512
400	315	5810	890	96.5	F	2361.5	1.10	2.00	93.00	93.50	94.70	0.70	0.78	0.82	495.957	20.0	6063
450	355	5810	890	107.1	F	2656.6	1.00	2.00	93.10	93.70	94.80	0.70	0.79	0.83	504.263	20.0	6614
500	400	6806	890	118.9	F	2951.8	1.00	2.00	93.20	93.80	94.90	0.70	0.79	0.83	781.192	20.0	7716
600	450	6807	891	142.5	F	3538.2	0.90	1.90	93.40	93.90	95.00	0.71	0.79	0.83	861.399	20.0	7937
700	500	6808	891	165.9	F	4127.9	0.90	1.90	93.50	94.00	95.20	0.71	0.79	0.83	925.470	20.0	8157
750	560	6809	891	177.6	F	4422.8	0.90	1.90	93.60	94.30	95.30	0.72	0.80	0.83	1008.525	20.0	8488
800	630	6809	891	186.7	F	4717.6	0.90	1.90	93.80	94.40	95.50	0.72	0.80	0.84	1122.429	20.0	8818
900	710	8007	891	209.4	F	5307.3	0.90	1.90	94.00	94.60	95.80	0.72	0.80	0.84	1469.836	20.0	11684
1000	800	8008	892	232.0	F	5890.4	0.90	1.90	94.10	94.80	96.10	0.74	0.81	0.84	1624.556	20.0	13338
1250	900	8806	892	286.3	F	7363.0	0.90	1.90	94.20	95.00	96.20	0.75	0.81	0.85	2444.190	20.0	13448
1350	1000	8807	892	309.2	F	7952.0	0.90	1.90	94.40	95.10	96.20	0.75	0.81	0.85	2679.117	20.0	13999
1500	1120	8808	893	342.8	F	8825.7	0.90	1.90	94.60	95.20	96.40	0.76	0.81	0.85	2973.369	20.0	15542
1750	1250	8809	893	399.5	F	10296.6	0.90	1.90	94.70	95.30	96.50	0.76	0.81	0.85	3122.156	20.0	16424
2000	1400	9607	893	453.2	F	11767.6	0.80	1.80	94.50	95.10	96.10	0.75	0.81	0.86	4983.300	20.0	18519
2250	1600	9608	893	509.8	F	13238.5	0.80	1.80	94.50	95.10	96.10	0.75	0.81	0.86	5937.958	20.0	21385
2500	1800	10407	893	564.7	F	14709.5	0.80	1.80	94.60	95.30	96.40	0.75	0.81	0.86	6881.700	20.0	23589

NOTE: The values shown are subject to change without prior notice.

THREE-PHASE INDUCTION MOTORS
HGF LINE - 2300V - 60Hz - TEFC (IP55)
INSULATION CLASS F - SERVICE FACTOR 1.15
TEMPERATURE RISE 80°C AT SERVICE FACTOR 1.0



Power		NEMA Frame	RPM	FULL LOAD AMPS	KVA /HP CODE	Tn Ft.lb	Ti/Tn	Tb/Tn	% OF FULL LOAD						INERTIA lb.Ft²	LRT sec.	Approx. WEIGHT lb
									EFFICIENCY			POWER FACTOR					
									50	75	100	50	75	100			

10 POLE

175	125	5809	710	53.4	J	1295.1	1.20	2.10	90.80	92.30	93.00	0.45	0.58	0.66	363.07	20.0	5071
200	140	5810	710	61.0	J	1480.1	1.20	2.10	90.80	92.30	93.00	0.45	0.58	0.66	403.41	20.0	5512
225	160	5810	710	68.4	J	1665.1	1.20	2.10	91.00	92.80	93.40	0.45	0.58	0.66	469.85	20.0	5842
250	180	5811	710	75.9	J	1850.1	1.20	2.10	91.00	92.80	93.40	0.45	0.58	0.66	538.67	20.0	6283
275	200	5812	710	83.5	J	2035.1	1.20	2.10	91.00	92.80	93.40	0.45	0.58	0.66	564.77	20.0	6614
300	225	6806	710	79.3	H	2220.1	1.00	2.00	93.80	94.20	94.40	0.57	0.69	0.75	764.11	20.0	7937
350	250	6807	710	92.6	H	2590.1	1.00	2.00	93.80	94.20	94.40	0.57	0.69	0.75	847.16	20.0	8598
370	280	6807	710	97.9	H	2738.1	1.00	2.00	93.80	94.20	94.40	0.57	0.69	0.75	866.14	20.0	8818
400	315	8007	710	105.6	H	2960.1	0.80	1.80	93.90	94.40	94.60	0.57	0.69	0.75	1136.67	20.0	10472
450	355	8008	710	118.8	H	3330.1	0.80	1.80	93.90	94.40	94.60	0.57	0.69	0.75	1165.14	20.0	10692
500	400	8009	710	129.4	H	3700.2	0.80	1.80	94.20	95.00	95.20	0.57	0.70	0.76	1518.72	20.0	11684
600	450	8010	710	155.3	H	4440.2	0.80	1.80	94.20	95.00	95.20	0.57	0.70	0.76	1786.87	20.0	13338
700	500	8010	710	181.2	H	5180.2	0.80	1.80	94.20	95.00	95.20	0.57	0.70	0.76	1933.99	20.0	13448
750	560	8806	714	193.5	G	5519.2	0.80	1.80	94.50	95.40	95.50	0.57	0.70	0.76	2759.79	20.0	17196
800	630	8807	714	206.4	G	5887.1	0.80	1.80	94.50	95.40	95.50	0.57	0.70	0.76	2970.99	20.0	18519
900	710	8808	714	232.2	G	6623.0	0.80	1.80	94.50	95.40	95.50	0.57	0.70	0.76	3426.61	20.0	20944
1000	800	9606	714	256.7	G	7358.9	0.80	1.80	94.70	95.50	96.00	0.58	0.70	0.76	5291.79	20.0	24802
1250	900	9607	714	320.8	G	9198.6	0.80	1.80	94.70	95.50	96.00	0.58	0.70	0.76	6110.47	20.0	28660
1350	1000	10407	710	330.5	G	9990.4	0.80	1.80	94.10	94.70	95.60	0.68	0.75	0.80	5220.60	21.0	22707
1500	1120	10408	710	366.1	G	11100.5	0.80	1.80	94.20	94.90	95.90	0.68	0.75	0.80	6169.80	21.0	23810
1750	1250	10408	710	426.3	G	12950.6	0.80	1.80	94.30	95.00	96.10	0.68	0.75	0.80	7119.00	21.0	24692

12 POLE

200	140	6806	594	55.9	H	1769.1	0.90	2.00	91.00	92.00	93.00	0.55	0.67	0.72	652.57	20.0	8488
225	160	6808	594	62.7	H	1990.2	0.90	2.00	91.00	92.40	93.40	0.55	0.67	0.72	723.76	20.0	8708
250	180	6809	594	69.5	H	2211.4	0.90	2.00	92.00	94.60	93.60	0.55	0.67	0.72	794.95	20.0	9149
275	200	6810	594	76.4	H	2432.5	0.90	2.00	92.00	94.60	93.60	0.55	0.67	0.72	866.14	20.0	9370
300	225	8008	594	82.5	G	2653.7	0.80	2.00	93.50	94.40	94.60	0.56	0.69	0.72	901.74	20.0	11023
350	250	8008	594	96.2	G	3095.9	0.80	2.00	93.50	94.40	94.60	0.56	0.69	0.72	1067.85	20.0	12125
370	280	8009	594	101.5	G	3272.8	0.80	2.00	93.60	94.50	94.80	0.56	0.69	0.72	1233.96	20.0	12566
400	315	8010	594	109.6	G	3538.2	0.80	2.00	94.00	94.70	94.90	0.56	0.69	0.72	1423.80	20.0	13007
450	355	8011	594	123.1	G	3980.5	0.80	2.00	94.20	94.90	95.10	0.56	0.69	0.72	1613.64	20.0	13889
500	400	8808	594	131.3	G	4422.8	0.80	2.00	94.00	95.00	95.10	0.60	0.70	0.75	2159.43	21.0	17416
600	450	8809	594	157.5	G	5307.3	0.80	2.00	94.10	95.00	95.10	0.60	0.70	0.75	2444.19	21.0	18519
700	500	8810	594	183.4	G	6191.9	0.80	2.00	94.10	95.10	95.30	0.60	0.70	0.75	2728.95	21.0	19841
750	560	9608	594	196.9	G	6634.1	0.80	2.00	94.20	95.00	95.10	0.60	0.70	0.75	4746.00	20.0	29101
800	630	9609	594	209.6	G	7076.4	0.80	2.00	94.30	95.10	95.30	0.60	0.70	0.75	5244.33	20.0	30864
900	710	9610	594	235.3	G	7961.0	0.80	2.00	94.30	95.30	95.50	0.60	0.70	0.75	5742.66	20.0	32849
1000	800	10408	595	256.7	G	8830.6	0.80	2.00	94.50	95.50	96.00	0.60	0.71	0.76	7403.76	20.0	26235
1250	900	10409	595	320.8	G	11038.3	0.80	2.00	94.50	95.50	96.00	0.60	0.71	0.76	7878.36	20.0	28219
1350	1000	10410	595	346.5	G	11921.4	0.80	2.00	94.50	95.50	96.00	0.60	0.71	0.76	8827.56	20.0	30864

NOTE: The values shown are subject to change without prior notice.

THREE-PHASE INDUCTION MOTORS
HGF LINE - 4160V - 60Hz - TEFC (IP55)
INSULATION CLASS F - SERVICE FACTOR 1.15
TEMPERATURE RISE 80°C AT SERVICE FACTOR 1.0



Power		NEMA Frame	RPM	FULL LOAD AMPS	KVA /HP CODE	Tn Ft.lb	Ti/Tn	Tb/Tn	% OF FULL LOAD						INERTIA lb.Ft²	LRT sec.	Approx. WEIGHT lb
									EFFICIENCY			POWER FACTOR					
HP	KW																

6 POLE

135	100	5006	1180	18.4	F	601.1	1.30	2.00	91.30	92.10	92.50	0.68	0.76	0.82	113.91	20.0	2646
150	112	5006	1180	20.5	F	667.9	1.30	2.00	91.50	92.30	92.60	0.68	0.76	0.82	123.40	20.0	2756
175	125	5007	1180	23.8	F	779.2	1.30	2.00	91.60	92.50	92.80	0.68	0.72	0.82	140.01	20.0	2866
200	140	5007	1180	27.2	F	890.6	1.30	2.00	91.80	92.60	93.00	0.69	0.76	0.82	156.62	20.0	2976
225	160	5008	1180	30.5	F	1001.9	1.30	2.00	92.00	92.80	93.20	0.69	0.77	0.82	158.99	20.0	3086
250	180	5009	1180	33.4	F	1113.2	1.30	2.00	92.30	93.00	93.50	0.70	0.77	0.83	187.47	20.0	3417
275	200	5009	1180	36.6	F	1224.5	1.30	2.00	92.60	93.10	93.80	0.71	0.78	0.83	201.70	20.0	3593
300	225	5010	1180	39.8	F	1335.8	1.30	2.00	92.80	93.40	94.00	0.72	0.78	0.83	223.06	20.0	3748
350	250	5011	1181	46.3	F	1557.1	1.30	2.00	93.00	93.50	94.30	0.72	0.78	0.83	246.79	20.0	3968
370	280	5011	1181	48.3	F	1646.1	1.30	2.00	93.00	93.80	94.50	0.73	0.79	0.84	265.78	20.0	4189
400	315	5810	1181	52.0	F	1779.6	1.20	2.00	93.20	94.00	94.80	0.73	0.79	0.84	270.52	20.0	5512
450	355	5811	1182	58.4	F	2000.3	1.20	2.00	93.40	94.20	95.00	0.73	0.79	0.84	301.37	20.0	5842
500	400	5812	1182	64.7	F	2222.6	1.20	2.00	93.60	94.40	95.20	0.73	0.79	0.84	344.08	20.0	6173
600	450	5812	1182	77.6	F	2667.1	1.20	2.00	93.70	94.50	95.30	0.74	0.80	0.84	379.68	20.0	6504
700	500	6807	1185	90.3	F	3103.8	1.20	2.00	93.80	94.60	95.50	0.74	0.80	0.84	412.90	20.0	7165
750	560	6808	1186	96.6	F	3322.7	1.20	2.00	94.00	94.80	95.70	0.74	0.80	0.84	462.74	20.0	7716
800	630	6809	1185	101.7	F	3547.2	1.10	1.90	94.00	94.90	95.80	0.74	0.81	0.85	505.45	20.0	8157
900	710	6810	1185	114.2	F	3990.6	1.10	1.90	94.10	95.00	96.00	0.74	0.81	0.85	567.15	20.0	8598
1000	800	8009	1187	125.3	F	4426.5	1.00	1.90	94.20	95.10	96.10	0.75	0.82	0.86	963.44	20.0	10251
1250	900	8010	1187	156.4	F	5533.1	1.00	1.90	94.40	95.20	96.20	0.76	0.82	0.86	1074.97	20.0	11354
1350	1000	8010	1187	168.8	F	5975.7	1.00	1.90	94.50	95.30	96.30	0.76	0.83	0.86	1167.52	20.0	11795
1500	1120	8806	1188	187.3	F	6634.1	0.90	1.80	94.70	95.40	96.40	0.76	0.83	0.86	1661.10	20.0	12236
1750	1250	8807	1188	218.3	F	7739.8	0.90	1.80	94.80	95.50	96.50	0.77	0.83	0.86	2147.56	20.0	13117
2000	1400	8808	1188	249.5	F	8845.5	0.90	1.80	95.00	95.50	96.50	0.77	0.83	0.86	2354.02	20.0	15212
2250	1600	9606	1190	277.2	F	9934.5	0.80	1.80	95.00	95.60	96.60	0.78	0.84	0.87	2728.95	20.0	15873
2500	1800	9607	1190	308.0	F	11038.3	0.80	1.80	95.10	95.70	96.60	0.78	0.84	0.87	3571.36	20.0	18629
2750	2000	9608	1190	339.1	F	12142.1	0.80	1.80	95.20	95.80	96.50	0.78	0.84	0.87	3875.11	20.0	19841
3000	2250	10408	1190	370.0	G	13246.0	0.80	1.80	95.20	95.80	96.50	0.78	0.84	0.87	4983.30	20.0	21605

8 POLE

135	100	5006	886	19.4	F	800.6	1.20	2.00	91.30	92.00	92.30	0.66	0.74	0.78	149.50	20.0	2976
150	112	5007	886	21.5	F	889.5	1.20	2.00	91.50	92.10	92.50	0.66	0.74	0.78	152.82	20.0	3086
175	125	5008	886	24.7	F	1037.8	1.20	2.00	91.70	92.30	93.00	0.67	0.74	0.79	168.01	20.0	3197
200	140	5009	887	28.1	F	1184.7	1.20	2.00	91.90	92.50	93.20	0.67	0.75	0.79	204.08	20.0	3417
225	160	5009	887	31.5	F	1332.8	1.20	2.00	92.00	92.60	93.50	0.67	0.75	0.79	246.79	20.0	3638
250	180	5010	888	34.5	F	1479.2	1.20	2.00	92.20	92.80	93.70	0.67	0.76	0.80	256.28	20.0	3858
275	200	5011	888	37.9	F	1627.2	1.20	2.00	92.30	92.90	93.90	0.68	0.76	0.80	266.25	20.0	4079
300	225	5807	889	40.8	F	1773.1	1.10	2.00	92.50	93.00	94.10	0.68	0.76	0.81	341.71	20.0	5071
350	250	5808	889	47.4	F	2068.6	1.10	2.00	92.60	93.20	94.30	0.70	0.76	0.81	387.51	20.0	5291
370	280	5809	890	49.4	F	2184.3	1.10	2.00	92.80	93.30	94.50	0.70	0.78	0.82	433.07	20.0	5512
400	315	5810	890	53.3	F	2361.5	1.10	2.00	93.00	93.50	94.70	0.70	0.78	0.82	495.96	20.0	6063
450	355	5810	890	59.2	F	2656.6	1.00	2.00	93.10	93.70	94.80	0.70	0.79	0.83	504.27	20.0	6614
500	400	6806	890	65.7	F	2951.8	1.00	2.00	93.20	93.80	94.90	0.70	0.79	0.83	781.19	20.0	7716
600	450	6807	891	78.8	F	3538.2	0.90	1.90	93.40	93.90	95.00	0.71	0.79	0.83	861.40	20.0	7937
700	500	6808	891	91.7	F	4127.9	0.90	1.90	93.50	94.00	95.20	0.71	0.79	0.83	925.47	20.0	8157
750	560	6809	891	98.2	F	4422.8	0.90	1.90	93.60	94.30	95.30	0.72	0.80	0.83	1008.53	20.0	8488
800	630	6809	891	103.3	F	4717.6	0.90	1.90	93.80	94.40	95.50	0.72	0.80	0.84	1122.43	20.0	8818
900	710	8007	891	115.8	F	5307.3	0.90	1.90	94.00	94.60	95.80	0.72	0.80	0.84	1469.84	20.0	11684
1000	800	8008	892	128.3	F	5890.4	0.90	1.90	94.10	94.80	96.10	0.74	0.81	0.84	1624.56	20.0	13338
1250	900	8806	892	158.3	F	7363.0	0.90	1.90	94.20	95.00	96.20	0.75	0.81	0.85	2444.19	20.0	13448
1350	1000	8807	892	170.9	F	7952.0	0.90	1.90	94.40	95.10	96.20	0.75	0.81	0.85	2679.12	20.0	13999
1500	1120	8808	893	189.5	F	8825.7	0.90	1.90	94.60	95.20	96.40	0.76	0.81	0.85	2973.37	20.0	15542
1750	1250	8809	893	220.9	F	10296.6	0.90	1.90	94.70	95.30	96.50	0.76	0.81	0.85	3122.16	20.0	16424
2000	1400	9607	893	250.5	F	11767.6	0.80	1.80	94.50	95.10	96.10	0.75	0.81	0.86	4983.30	20.0	18519
2250	1600	9608	893	281.9	F	13238.5	0.80	1.80	94.50	95.10	96.10	0.75	0.81	0.86	5937.96	20.0	21385
2500	1800	10407	893	312.2	F	14709.5	0.80	1.80	94.60	95.30	96.40	0.75	0.81	0.86	6881.70	20.0	23589

NOTE: The values shown are subject to change without prior notice.

THREE-PHASE INDUCTION MOTORS
HGF LINE - 4160V - 60Hz - TEFC (IP55)
INSULATION CLASS F - SERVICE FACTOR 1.15
TEMPERATURE RISE 80°C AT SERVICE FACTOR 1.0



Power		NEMA Frame	RPM	FULL LOAD AMPS	KVA /HP CODE	Tn Ft.lb	Ti/Tn	Tb/Tn	% OF FULL LOAD						INERTIA lb.Ft²	LRT sec.	Approx. WEIGHT lb
									EFFICIENCY			POWER FACTOR					
									50	75	100	50	75	100			

10 POLE

175	125	5809	710	29.5	J	1295.1	1.20	2.10	90.80	92.30	93.00	0.45	0.58	0.66	363.07	20.0	5071
200	140	5810	710	33.7	J	1480.1	1.20	2.10	90.80	92.30	93.00	0.45	0.58	0.66	403.41	20.0	5512
225	160	5810	710	37.8	J	1665.1	1.20	2.10	91.00	92.80	93.40	0.45	0.58	0.66	469.85	20.0	5842
250	180	5811	710	42.0	J	1850.1	1.20	2.10	91.00	92.80	93.40	0.45	0.58	0.66	538.67	20.0	6283
275	200	5812	710	46.2	J	2035.1	1.20	2.10	91.00	92.80	93.40	0.45	0.58	0.66	564.77	20.0	6614
300	225	6806	710	43.9	H	2220.1	1.00	2.00	93.80	94.20	94.40	0.57	0.69	0.75	764.11	20.0	7937
350	250	6807	710	51.2	H	2590.1	1.00	2.00	93.80	94.20	94.40	0.57	0.69	0.75	847.16	20.0	8598
370	280	6807	710	54.1	H	2738.1	1.00	2.00	93.80	94.20	94.40	0.57	0.69	0.75	866.14	20.0	8818
400	315	8007	710	58.4	H	2960.1	0.80	1.80	93.90	94.40	94.60	0.57	0.69	0.75	1136.67	20.0	10472
450	355	8008	710	65.7	H	3330.1	0.80	1.80	93.90	94.40	94.60	0.57	0.69	0.75	1165.14	20.0	10692
500	400	8009	710	71.5	H	3700.2	0.80	1.80	94.20	95.00	95.20	0.57	0.70	0.76	1518.72	20.0	11684
600	450	8010	710	85.9	H	4440.2	0.80	1.80	94.20	95.00	95.20	0.57	0.70	0.76	1786.87	20.0	13338
700	500	8010	710	100.2	H	5180.2	0.80	1.80	94.20	95.00	95.20	0.57	0.70	0.76	1933.99	20.0	13448
750	560	8806	714	107.0	G	5519.2	0.80	1.80	94.50	95.40	95.50	0.57	0.70	0.76	2759.80	20.0	17196
800	630	8807	714	114.1	G	5887.1	0.80	1.80	94.50	95.40	95.50	0.57	0.70	0.76	2970.99	20.0	18519
900	710	8808	714	128.4	G	6623.0	0.80	1.80	94.50	95.40	95.50	0.57	0.70	0.76	3426.61	20.0	20944
1000	800	9606	714	141.9	G	7358.9	0.80	1.80	94.70	95.50	96.00	0.58	0.70	0.76	5291.79	20.0	24802
1250	900	9607	714	177.4	G	9198.6	0.80	1.80	94.70	95.50	96.00	0.58	0.70	0.76	6110.47	20.0	28660
1350	1000	10407	710	182.8	G	9990.4	0.80	1.80	94.10	94.70	95.60	0.68	0.75	0.80	5220.60	21.0	22707
1500	1120	10408	710	202.4	G	11100.5	0.80	1.80	94.20	94.90	95.90	0.68	0.75	0.80	6169.80	21.0	23810
1750	1250	10408	710	235.7	G	12950.6	0.80	1.80	94.30	95.00	96.10	0.68	0.75	0.80	7119.00	21.0	24692

12 POLE

200	140	6806	594	30.9	H	1769.1	0.90	2.00	91.00	92.00	93.00	0.55	0.67	0.72	652.57	20.0	8488
225	160	6808	594	34.6	H	1990.2	0.90	2.00	91.00	92.40	93.40	0.55	0.67	0.72	723.76	20.0	8708
250	180	6809	594	38.4	H	2211.4	0.90	2.00	92.00	94.60	93.60	0.55	0.67	0.72	794.95	20.0	9149
275	200	6810	594	42.2	H	2432.5	0.90	2.00	92.00	94.60	93.60	0.55	0.67	0.72	866.14	20.0	9370
300	225	8008	594	45.6	G	2653.7	0.80	2.00	93.50	94.40	94.60	0.56	0.69	0.72	901.74	20.0	11023
350	250	8008	594	53.2	G	3095.9	0.80	2.00	93.50	94.40	94.60	0.56	0.69	0.72	1067.85	20.0	12125
370	280	8009	594	56.1	G	3272.8	0.80	2.00	93.60	94.50	94.80	0.56	0.69	0.72	1233.96	20.0	12566
400	315	8010	594	60.6	G	3538.2	0.80	2.00	94.00	94.70	94.90	0.56	0.69	0.72	1423.80	20.0	13007
450	355	8011	594	68.0	G	3980.5	0.80	2.00	94.20	94.90	95.10	0.56	0.69	0.72	1613.64	20.0	13889
500	400	8808	594	72.6	G	4422.8	0.80	2.00	94.00	95.00	95.10	0.60	0.70	0.75	2159.43	21.0	17416
600	450	8809	594	87.1	G	5307.3	0.80	2.00	94.10	95.00	95.10	0.60	0.70	0.75	2444.19	21.0	18519
700	500	8810	594	101.4	G	6191.9	0.80	2.00	94.10	95.10	95.30	0.60	0.70	0.75	2728.95	21.0	19841
750	560	9608	594	108.9	G	6634.1	0.80	2.00	94.20	95.00	95.10	0.60	0.70	0.75	4746.00	20.0	29101
800	630	9609	594	115.9	G	7076.4	0.80	2.00	94.30	95.10	95.30	0.60	0.70	0.75	5244.33	20.0	30864
900	710	9610	594	130.1	G	7961.0	0.80	2.00	94.30	95.30	95.50	0.60	0.70	0.75	5742.66	20.0	32849
1000	800	10408	595	141.9	G	8830.6	0.80	2.00	94.50	95.50	96.00	0.60	0.71	0.76	7403.76	20.0	26235
1250	900	10409	595	177.4	G	11038.3	0.80	2.00	94.50	95.50	96.00	0.60	0.71	0.76	7878.36	20.0	28219
1350	1000	10410	595	191.6	G	11921.4	0.80	2.00	94.50	95.50	96.00	0.60	0.71	0.76	8827.56	20.0	30864

NOTE: The values shown are subject to change without prior notice.

THREE-PHASE INDUCTION MOTORS
HGF LINE - 6600V - 60Hz - TEFC (IP55)
INSULATION CLASS F - SERVICE FACTOR 1.15
TEMPERATURE RISE 80°C AT SERVICE FACTOR 1.0



Power		NEMA Frame	RPM	FULL LOAD AMPS	KVA /HP CODE	Tn Ft.lb	Ti/Tn	Tb/Tn	% OF FULL LOAD						INERTIA lb.Ft²	LRT sec.	Approx. WEIGHT lb
									EFFICIENCY			POWER FACTOR					
									50	75	100	50	75	100			
6 POLE																	
200	140	5007	1180	17.4 G	G	890.6	1.30	2.00	91.60	92.40	92.80	0.68	0.75	0.81	196.96	20.0	3197
225	160	5008	1180	19.5 G	G	1001.9	1.30	2.00	91.80	92.60	93.00	0.68	0.76	0.81	223.06	20.0	3483
250	180	5009	1180	21.3 G	G	1113.2	1.30	2.00	92.10	92.80	93.30	0.69	0.76	0.82	242.05	20.0	3880
275	200	5010	1180	23.4 G	G	1224.5	1.30	2.00	92.40	92.90	93.60	0.70	0.77	0.82	263.40	20.0	4189
300	225	5809	1180	25.5 G	G	1335.8	1.30	2.00	92.60	93.20	93.80	0.71	0.77	0.82	263.88	20.0	4740
350	250	5809	1181	29.6 G	G	1557.1	1.30	2.00	92.80	93.30	94.10	0.71	0.77	0.82	291.64	20.0	4960
370	280	5810	1181	30.8 F	F	1646.1	1.30	2.00	92.80	93.60	94.30	0.72	0.78	0.83	313.24	20.0	5401
400	315	5811	1181	33.2 G	G	1779.6	1.20	2.00	93.00	93.80	94.60	0.72	0.78	0.83	353.10	20.0	5622
450	355	5812	1182	37.3 G	G	2000.3	1.20	2.00	93.20	94.00	94.80	0.72	0.78	0.83	377.07	20.0	5842
500	400	5812	1182	41.4 G	G	2222.6	1.20	2.00	93.40	94.20	95.00	0.72	0.78	0.83	379.68	20.0	6063
600	450	6807	1185	49.6 G	G	2660.4	1.00	1.90	93.50	94.30	95.10	0.73	0.79	0.83	412.90	20.0	6834
700	500	6808	1185	57.8 G	G	3103.8	1.00	1.90	93.60	94.40	95.30	0.73	0.79	0.83	462.73	20.0	7055
750	560	6810	1185	61.7 G	G	3325.5	1.00	1.90	93.80	94.60	95.50	0.73	0.79	0.83	505.45	20.0	7606
800	630	6811	1185	65.0 F	F	3547.2	1.00	1.90	93.80	94.70	95.60	0.73	0.80	0.84	567.15	20.0	8047
900	710	8010	1185	73.0 F	F	3990.6	1.00	1.90	93.90	94.80	95.80	0.73	0.80	0.84	875.16	20.0	10251
1000	800	8010	1185	81.0 F	F	4434.0	1.00	1.90	94.00	94.90	95.90	0.73	0.80	0.84	986.22	20.0	10803
1250	900	8010	1185	100.0 F	F	5542.4	1.00	1.90	94.20	95.00	96.00	0.75	0.82	0.85	1139.04	20.0	11795
1350	1000	8807	1188	107.9 F	F	5970.7	0.90	1.80	94.30	95.10	96.10	0.75	0.82	0.85	1346.91	20.0	12897
1500	1120	8808	1188	119.7 F	F	6634.1	0.90	1.80	94.50	95.20	96.20	0.75	0.82	0.85	1508.75	20.0	13669
1750	1250	8809	1188	139.5 F	F	7739.8	0.90	1.80	94.60	95.30	96.30	0.76	0.82	0.85	2349.27	20.0	15212
2000	1400	9607	1190	159.4 F	F	8830.6	0.80	1.80	94.80	95.30	96.30	0.76	0.82	0.85	1932.57	21.0	16755
2250	1600	9608	1190	177.1 F	F	9934.5	0.80	1.80	94.80	95.40	96.40	0.77	0.83	0.86	2208.79	21.0	19511
2500	1800	9609	1190	196.8 F	F	11038.3	0.80	1.80	94.90	95.50	96.40	0.77	0.83	0.86	2484.77	21.0	20833
2750	2000	10407	1190	216.5 G	G	12142.1	0.80	1.80	94.90	95.50	96.40	0.77	0.83	0.86	4746.00	21.0	20503
3000	2250	10408	1190	236.1 G	G	13246.0	0.80	1.80	94.90	95.50	96.40	0.77	0.83	0.86	5220.60	21.0	23148

8 POLE

135	100	5807	886	12.4 F	F	800.6	1.20	2.00	91.30	92.00	92.30	0.65	0.73	0.77	239.44	21.0	3527
150	112	5808	886	13.7 F	F	889.5	1.20	2.00	91.50	92.10	92.50	0.65	0.73	0.77	271.95	21.0	3748
175	125	5808	886	15.7 F	F	1037.8	1.20	2.00	91.70	92.30	93.00	0.66	0.73	0.78	304.46	21.0	3968
200	140	5809	887	18.0 F	F	1184.7	1.20	2.00	91.90	92.50	93.20	0.66	0.74	0.78	324.15	21.0	4519
225	160	5809	887	20.1 F	F	1332.8	1.20	2.00	92.00	92.60	93.50	0.66	0.74	0.78	350.25	21.0	4740
250	180	5810	888	22.0 F	F	1479.2	1.20	2.00	92.20	92.80	93.70	0.66	0.75	0.79	369.71	21.0	5071
275	200	5810	888	24.2 F	F	1627.2	1.20	2.00	92.30	92.90	93.90	0.67	0.75	0.79	415.27	21.0	5291
300	225	5811	889	26.0 F	F	1773.1	1.10	2.00	92.50	93.00	94.10	0.67	0.75	0.80	467.48	21.0	5512
350	250	5811	889	30.3 F	F	2068.6	1.10	2.00	92.60	93.20	94.30	0.69	0.75	0.80	474.60	21.0	5842
370	280	5812	890	31.5 F	F	2184.3	1.10	2.00	92.80	93.30	94.50	0.69	0.77	0.81	498.33	21.0	6173
400	315	5812	890	34.0 F	F	2361.5	1.10	2.00	93.00	93.50	94.70	0.69	0.77	0.81	522.06	21.0	6393
450	355	6806	890	37.8 F	F	2656.6	1.00	2.00	93.10	93.70	94.80	0.69	0.78	0.82	780.72	20.0	7496
500	400	6807	891	41.9 F	F	2948.5	1.00	2.00	93.20	93.80	94.90	0.70	0.78	0.82	861.40	20.0	7716
600	450	6808	891	50.3 F	F	3538.2	1.00	2.00	93.40	93.90	95.00	0.70	0.78	0.82	925.47	20.0	7937
700	500	6808	891	58.5 F	F	4127.9	1.00	2.00	93.50	94.00	95.20	0.70	0.78	0.82	1008.52	20.0	8267
750	560	6809	891	62.6 F	F	4422.8	1.00	2.00	93.60	94.30	95.30	0.71	0.79	0.82	1115.31	20.0	8598
800	630	8006	891	66.7 F	F	4717.6	0.90	1.90	93.80	94.40	95.50	0.71	0.79	0.82	1468.89	20.0	11243
900	710	8008	891	73.9 F	F	5307.3	0.90	1.90	94.00	94.60	95.80	0.72	0.80	0.83	1637.37	20.0	12346
1000	800	8806	892	81.8 F	F	5890.4	0.90	1.90	94.10	94.80	96.10	0.73	0.80	0.83	2444.19	20.0	13338
1250	900	8807	892	100.9 F	F	7363.0	0.90	1.90	94.20	95.00	96.20	0.74	0.80	0.84	2679.12	20.0	13779
1350	1000	8807	892	109.0 F	F	7952.0	0.90	1.90	94.40	95.10	96.20	0.74	0.80	0.84	2991.88	20.0	14550
1500	1120	8808	893	120.9 F	F	8825.7	0.90	1.90	94.60	95.20	96.40	0.75	0.80	0.84	3122.87	20.0	15432
1750	1250	9607	893	141.0 F	F	10296.6	0.90	1.80	94.60	95.20	96.40	0.75	0.80	0.84	4983.30	20.0	18519
2000	1400	9608	893	161.2 F	F	11767.6	0.90	1.80	94.60	95.20	96.40	0.75	0.80	0.84	5932.50	20.0	21274
2250	1600	10409	893	181.1 G	G	13238.5	0.80	1.80	94.60	95.30	96.50	0.75	0.80	0.84	6407.10	20.0	24251

NOTE: The values shown are subject to change without prior notice.

THREE-PHASE INDUCTION MOTORS
HGF LINE - 6600V - 60Hz - TEFC (IP55)
INSULATION CLASS F - SERVICE FACTOR 1.15
TEMPERATURE RISE 80°C AT SERVICE FACTOR 1.0



Power		NEMA Frame	RPM	FULL LOAD AMPS	KVA /HP CODE	Tn Ft.lb	Tl/Tn	Tb/Tn	% OF FULL LOAD						INERTIA lb.Ft²	LRT sec.	Approx. WEIGHT lb
									EFFICIENCY			POWER FACTOR					
HP	KW								50	75	100	50	75	100			
10 POLE																	
200	140	5810	710	21.5 J	J	1480.1	1.20	2.10	90.00	91.80	92.10	0.45	0.58	0.66	429.51	20.0	5291
225	160	5811	710	24.2 J	J	1665.1	1.20	2.10	90.00	91.80	92.10	0.45	0.58	0.66	449.68	20.0	5512
250	180	5811	710	26.8 J	J	1850.1	1.20	2.10	90.20	92.00	92.30	0.45	0.58	0.66	517.31	20.0	6063
275	200	5812	710	29.5 J	J	2035.1	1.20	2.10	90.20	92.00	92.30	0.45	0.58	0.66	564.77	20.0	6614
300	225	6806	710	29.8 H	H	2220.1	0.90	2.00	92.80	93.80	94.00	0.54	0.65	0.70	764.10	20.0	8598
350	250	6807	710	34.7 H	H	2590.1	0.90	2.00	92.80	93.80	94.00	0.54	0.65	0.70	844.79	20.0	9149
370	280	6807	710	36.7 H	H	2738.1	0.90	2.00	92.80	93.80	94.00	0.54	0.65	0.70	866.14	20.0	9370
400	315	8007	710	39.0 H	H	2960.1	0.80	1.90	92.90	94.00	94.20	0.55	0.66	0.71	1160.39	20.0	10692
450	355	8008	710	42.4 G	G	3330.1	0.80	1.90	93.80	94.60	94.80	0.56	0.67	0.73	1525.84	20.0	11684
500	400	8009	710	47.1 G	G	3700.2	0.80	1.90	93.80	94.60	94.80	0.56	0.67	0.73	1791.61	20.0	13338
600	450	8010	710	55.1 G	G	4440.2	0.80	1.90	93.80	94.60	94.80	0.57	0.69	0.75	1933.99	20.0	13448
700	500	8010	710	64.2 G	G	5180.2	0.80	1.90	93.80	94.60	94.80	0.57	0.69	0.75	2097.73	20.0	14661
750	560	8806	714	67.6 G	G	5519.2	0.80	1.80	94.20	95.00	95.20	0.58	0.70	0.76	2892.68	20.0	18078
800	630	8807	714	72.2 G	G	5887.1	0.80	1.80	94.20	95.00	95.20	0.58	0.70	0.76	3269.99	20.0	20393
900	710	9606	714	80.5 G	G	6623.0	0.80	1.80	94.70	95.50	96.00	0.58	0.70	0.76	5282.30	20.0	24802
1000	800	9607	714	89.4 G	G	7358.9	0.80	1.80	94.70	95.50	96.00	0.58	0.70	0.76	6364.39	20.0	29762
1250	900	9608	714	111.8 G	G	9198.6	0.80	1.80	94.70	95.50	96.00	0.58	0.70	0.76	7175.95	20.0	33510
1350	1000	10407	710	117.5 G	G	9990.4	0.80	1.80	94.20	95.00	96.10	0.68	0.75	0.78	6169.80	21.0	23589
1500	1120	10408	710	130.6 G	G	11100.5	0.80	1.80	94.20	95.00	96.10	0.68	0.75	0.78	6881.70	21.0	25353

12 POLE

200	140	6806	594	19.5 H	H	1769.1	0.90	2.00	91.00	92.00	93.00	0.55	0.67	0.72	652.57	20.0	8488
225	160	6808	594	21.8 H	H	1990.2	0.90	2.00	91.00	92.40	93.40	0.55	0.67	0.72	723.76	20.0	8708
250	180	6809	594	24.2 H	H	2211.4	0.90	2.00	92.00	94.60	93.60	0.55	0.67	0.72	794.95	20.0	9149
275	200	6810	594	26.6 H	H	2432.5	0.90	2.00	92.00	94.60	93.60	0.55	0.67	0.72	866.14	20.0	9370
300	225	8008	594	28.7 G	G	2653.7	0.80	2.00	93.50	94.40	94.60	0.56	0.69	0.72	901.74	20.0	11023
350	250	8008	594	33.5 G	G	3095.9	0.80	2.00	93.50	94.40	94.60	0.56	0.69	0.72	1067.85	20.0	12125
370	280	8009	594	35.4 G	G	3272.8	0.80	2.00	93.60	94.50	94.80	0.56	0.69	0.72	1233.96	20.0	12566
400	315	8010	594	38.2 G	G	3538.2	0.80	2.00	94.00	94.70	94.90	0.56	0.69	0.72	1423.80	20.0	13007
450	355	8011	594	42.9 G	G	3980.5	0.80	2.00	94.20	94.90	95.10	0.56	0.69	0.72	1613.64	20.0	13889
500	400	8808	594	45.7 G	G	4422.8	0.80	2.00	94.00	95.00	95.10	0.60	0.70	0.75	2159.43	21.0	17416
600	450	8809	594	54.9 G	G	5307.3	0.80	2.00	94.10	95.00	95.10	0.60	0.70	0.75	2444.19	21.0	18519
700	500	8810	594	63.9 G	G	6191.9	0.80	2.00	94.10	95.10	95.30	0.60	0.70	0.75	2728.95	21.0	19841
750	560	9608	594	68.6 G	G	6634.1	0.80	2.00	94.20	95.00	95.10	0.60	0.70	0.75	4746.00	20.0	29101
800	630	9609	594	73.0 G	G	7076.4	0.80	2.00	94.30	95.10	95.30	0.60	0.70	0.75	5244.33	20.0	30864
900	710	9610	594	82.0 G	G	7961.0	0.80	2.00	94.30	95.30	95.50	0.60	0.70	0.75	5742.66	20.0	32849
1000	800	10408	595	89.4 G	G	8830.6	0.80	2.00	94.50	95.50	96.00	0.60	0.71	0.76	7403.76	20.0	26235
1250	900	10409	595	111.8 G	G	11038.3	0.80	2.00	94.50	95.50	96.00	0.60	0.71	0.76	7878.36	20.0	28219
1350	1000	10410	595	120.7 G	G	11921.4	0.80	2.00	94.50	95.50	96.00	0.60	0.71	0.76	8827.56	20.0	30864

NOTE: The values shown are subject to change without prior notice.

HGF LINE

Protection: IP54/W55
 Sleeve Bearings
 Cooling: TEFC

Voltage up to 6600 V
 Polarity: II, IV Pole or more

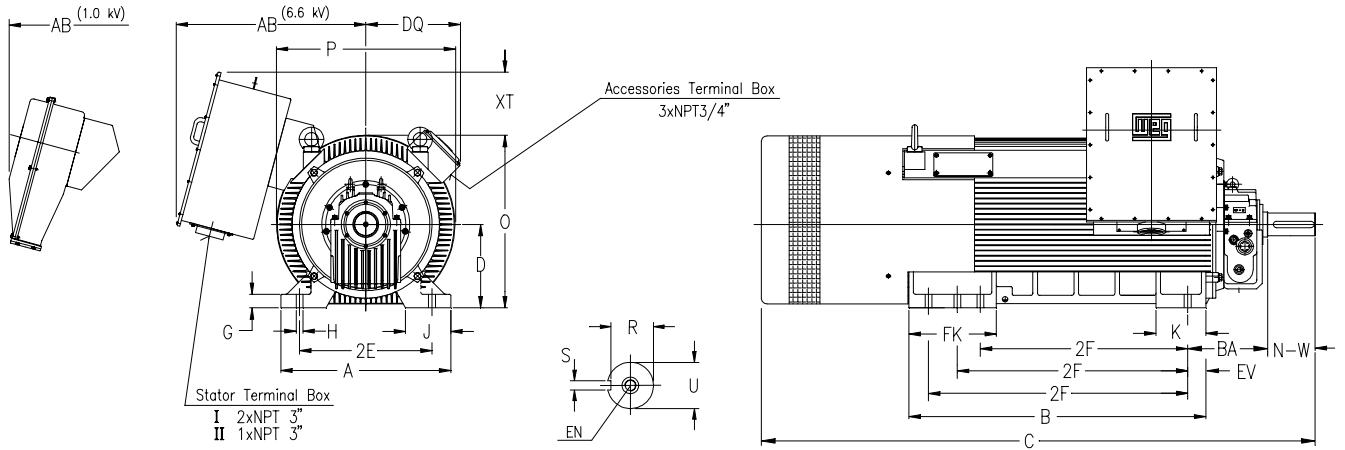

NEMA FRAME	Mounting				A	B	EV	D	G	J	K	FK	O	P	XT	I 1kV		DQ	SHAFT END																		
	2E	2F	H	BA												IV POLE OR MORE						II POLE															
																I	II		EN	U	R	S	N-W	C	EN	U	R	S	N-W	C							
50	06	20																15.3	UNC 7/8"	3.625	3.134	0.875	10.625	UNC 3/4"	2.375	2.021	0.625	4.75		80.0							
	07	22			30.3							10.2																									
	08	25			25.0		2.6	12.5	2.0	7.0	7.0		26.5	27.5																							
	09	28	1.2	14.76																																	
	10	32			41.3								13.3																			91.8					
58	07	25																																			
	08	28			39.3																																
	09	32			29.5		3.1	14.5	2.0	8.6	7.8	15.0	30.0	30.5																							
	10	36	1.2	16.73																																	
	11	40			51.2																													95.7			
68	06	28																																			
	07	32			42.1																																
	08	36	1.4	17.72	33.0		3.1	17.0	3.2	8.6	8.6	14.1	34.5	35.0																							
	09	40			51.0																																
	10	45																																			
80	06	32																																			
	07	36			47.2																																
	08	40	1.4	18.70	37.5		3.5	20.0	3.0	10	9.0	16.0	39.5	39.0																							
	09	45			58.0																																
	10	50																																			
88	06	36																																			
	07	40			55.0																																
	08	45	1.7	19.68	41.5		5.9	22.0	2.5	11.0	12.0	17.8	43.5	43.5																							
	09	50			66.0																																
	10	56																																			
96	06	40																																			
	07	45			61.0																																
	08	50	1.7	22.05	47.2		7.1	24.0	2.7	12.6	15.7	19.7	48.0	48.0																							
	09	56			74.8																																
	10	63																																			
104	06	36																																			
	07	40			61.0																																
	08	45	1.7	23.6	60.0		7.1	26.0	3.3	12.6	15.7	19.7	53.2	54.3																							
	09	50			74.8																																
	10	56																																			

- Second shaft end on request.
 - Bearings only for direct coupling (without axial or radial load).
 - The values shown are subject to change without prior notice.
 - For order or construction use only certified data.
- 1) As the motor is triple punched on the rear feet, there are three 2F dimensions per frame.
 - 2) As the motor is double punched on the rear feet, there are two 2F dimensions per frame.

HGF LINE



Protection: IP54/W55
 Ball/Roller Bearing
 Cooling: TEFC

Voltage up to 6600 V
 Polarity: II, IV Pole or more

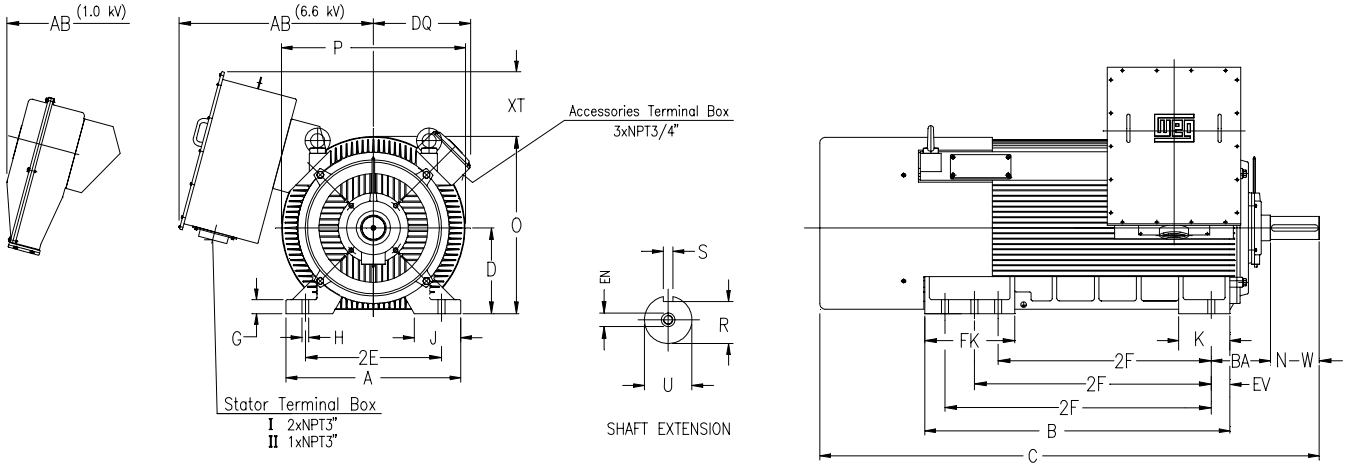

NEMA FRAME	Mounting				A	B	EV	D	G	J	K	FK	O	P	XT	AB	DQ	SHAFT END																																																																																									
	2E	2F	H	BA														IV POLE OR MORE					II POLE																																																																																				
																		EN	U	R	S	N-W	C	EN	U	R	S	N-W	C																																																																														
50	06	20			25.0	30.3	2.6	12.5	2.0	7.0	7.0	10.2	26.5	27.5	I 9.0 II 13.8	I 27.1 II 37.0	15.3	UNC 7/8"	3.625	3.134	0.875	10.625	64.4	UNC 3/4"	2.375	2.021	0.625	4.750	76.0																																																																														
	07	22																												1.2	8.50	29.5	3.1	14.5	2.0	8.6	7.8	15.0	30.0	30.5	I 7.7 II 13.1	I 27.1 II 38.0	16.5	UNC 7/8"	3.875	3.309	1.000	11.625	73.4	UNC 3/4"	2.375	2.021	0.625	4.750	76.0																																																				
	08	25																																																						1.4	11.5 12.5 (II Pole)	33.0	3.1	17.0	3.2	8.6	8.6	14.1	34.5	35.0	I 7.2 II 13.5	I 29.7 II 40.0	18.0	UNC 1"	4.375	3.817	1.000	11.625	86.0	UNC 3/4"	2.75	2.402	0.625	5.750	94.4																										
	09	28																																																																																1.4	12.5	37.5	3.5	20.0	3.0	10	9.0	16.0	39.5	39.0	I 6.9 II 11.5	I 30.6 II 41.7	19.5	UNC 1"	4.750	4.041	1.250	11.625	99.0	UNC 3/4"	2.375	2.021	0.625	4.750	76.0
	10	32																																																																																																									
11	36			1.7	15.0	47.2	7.1	24.0	2.7	12.6	15.7	19.7	48.0	48.0	I 6.0 II 11.8	I 35.0 II 45.0	24.5	UNC 1 1/4"	5.125	4.423	1.250	11.625	114.0	UNC 3/4"	2.375	2.021	0.625	4.750	76.0																																																																														
12	45																													1.7	16.0	60	7.1	26.0	2.7	12.6	15.7	19.7	53.2	54.3	I 7.5 II 11.8	I 39.4 II 48.4	24.5	UNC 1 1/4"	6.000	5.155	1.500	11.625	125.4	UNC 3/4"	2.375	2.021	0.625	4.750	76.0																																																				
13	50																																																							1.7	16.0	60	7.1	26.0	2.7	12.6	15.7	19.7	53.2	54.3	I 7.5 II 11.8	I 39.4 II 48.4	24.5	UNC 1 1/4"	6.000	5.155	1.500	11.625	125.4	UNC 3/4"	2.375	2.021	0.625	4.750	76.0																										
14	55			1.7	16.0	60	7.1	26.0	2.7	12.6	15.7	19.7	53.2	54.3	I 7.5 II 11.8	I 39.4 II 48.4	24.5	UNC 1 1/4"	6.000	5.155	1.500	11.625	125.4	UNC 3/4"	2.375	2.021	0.625	4.750	76.0																																																																														
15	60																													1.7	16.0	60	7.1	26.0	2.7	12.6	15.7	19.7	53.2	54.3	I 7.5 II 11.8	I 39.4 II 48.4	24.5	UNC 1 1/4"	6.000	5.155	1.500	11.625	125.4	UNC 3/4"	2.375	2.021	0.625	4.750	76.0																																																				
16	65																																																																																	1.7	16.0	60	7.1	26.0	2.7	12.6	15.7	19.7	53.2	54.3	I 7.5 II 11.8	I 39.4 II 48.4	24.5	UNC 1 1/4"	6.000	5.155	1.500	11.625	125.4	UNC 3/4"	2.375	2.021	0.625	4.750	76.0

PLEASE CONTACT WEG MAQUINAS

- Second shaft end on request.
- Bearings only for direct coupling (without axial or radial load).
- The values shown are subject to change without prior notice.
- For order or construction use only certified data.

- 1) As the motor is triple punched on the rear feet, there are three 2F dimensions per frame.
- 2) As the motor is double punched on the rear feet, there are two 2F dimensions per frame.

BEARING CHART

GREASE LUBRICATED BEARINGS



MOUNTING B3

FRAME		POLES	TORQUE kNm	DIRECT COUPLING		LUBRICATION		BELT COUPLING			
NEMA	IEC			D.E. BEARING	N.D.E. BEARING	(60 Hz)	(50 Hz)	D.E. BEARING	N.D.E. BEARING		
5006/11	315	2		6314-C3	6314-C3	GREASE		--	--		
		4-12		6320-C3	6316-C3			NU322-C3	6316-C3		
5807/12	355	2		6314-C3	6314-C3			--	--		
		4-12		6322-C3	6320-C3			NU324-C3	6320-C3		
6806/10	400	2*		6316-C3	6316-C3			--	--		
		2**		6220-C3	6220-C3			--	--		
		4-12		NU224-C3	6320-C3			NU228-C3	6320-C3		
8006/10	450	4-12		NU226-C3	6322-C3			PLEASE CONTACT WEG MÁQUINAS			
8806/10	500	4-12		NU226-C3	6322-C3						
9606/10	560	4		16	NU228-C3 + 6028-C3						
			24	NU232-C3 + 6032-C3	***	OIL					
		6-12	16	NU228-C3 + 6028-C3	GREASE						
			24	NU232-C3 + 6032-C3							
10406/10	630	4	24	23032 CCC3/W33	NU224-C3	***	OIL				
			38	23036 CCC3/W33		***	***				
		6	24	23032 CCC3/W33		GREASE	GREASE				
			38	23036 CCC3/W33		OIL	GREASE				
		8-12	24	23032 CCC3/W33		GREASE					
			38	23036 CCC3/W33							

1. Frame 315 and 355 II Pole, lubricated with grease "POLIREX EM".
2. (*) Frame 400 (II Pole / 60 Hz), oil ISO VG46 lubricated bearings.
(**) Frame 400 (II Pole / 50 Hz), grease "POLIREX EM" lubricated bearings.
3. Frame 450, 500 e 560 II Pole, contact Weg Máquinas.
4. For frame 315, 355 and 400 with belt coupling, AISI 4140H steel shaft and roller bearings.
5. Fixed D.E. and N.D.E. bearings for frame 355 to 500 with roller bearings.
6. Electrically insulated N.D.E. bearing for frame 450 and above.
7. Electrically insulated N.D.E. bearing and grounding brush in the D.E. side for machines suitable for V.F.D.
8. (***) Motors with sleeve bearings.
9. Bearings subject to change without prior notice.

NOTE: Temperature detector type PT100 - 1 per bearing.

INQUIRY ON A . C. MOTOR



From (company/person): Fax:

To (company/person): Fax:

Customer/Project: Phone:
 Contact Person: Fax:

MAIN FEATURES (obligatory information):

Type of Rotor: () Squirrel-Cage
 () Slip-Ring

Number of Pole: Frequency:
 Output: Degree of Protection:
 Voltage:

ADDITIONAL FEATURES (blanks not filled in will be taken as being information in brackets):

Model: (best option)	Duty Cycle: (S1)
Cooling System: (best option)	Starts/Hour: Standard
Service Factor: (1,0)	Duty Factor: (100 %)
Mounting: (F1)	Starting: (no load)
Class of Insulation: (F)	Starting Method: (D.O.L.)
Temperature Rise: (100°C)	Coupling: (direct)
Maximum Temperature: (40 °C)	Painting: (Standard)
Altitude: (1000 m)	Classified Area: (Non classified area)
Rotation Direction: (CW)	Standard: (NEMA MG1)

LOAD FEATURES:

Driven Machine: Rotation (rpm):
 Inertia (J = lb.Ft²): Attached Curve (yes/no):
 Absorved Output:

ACCESSORIES:

Space Heaters: Volts
 Winding Temperature Detector Type: (..... per winding)
 Bearings Temperature Detector Type: (..... per bearing)

NOTES:

INTERCHANGEABILITY BETWEEN MOTORS FITTED WITH FEET

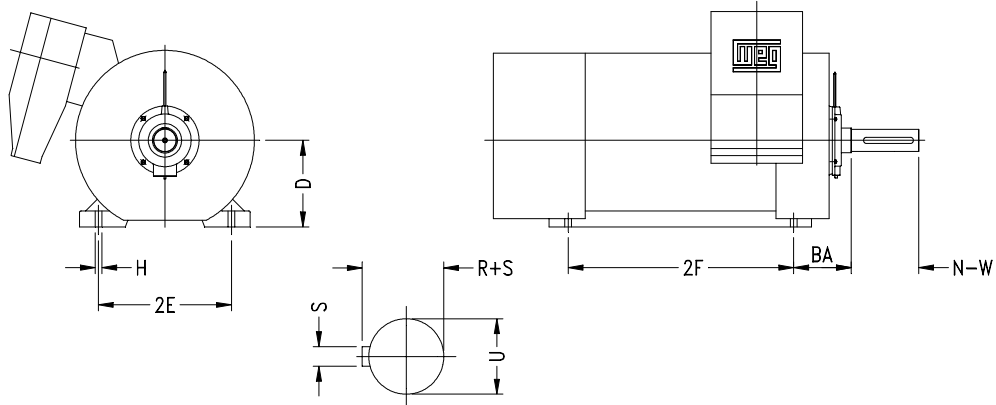

INTERCHANGEABILITY BETWEEN MOTORS FITTED WITH FLANGE

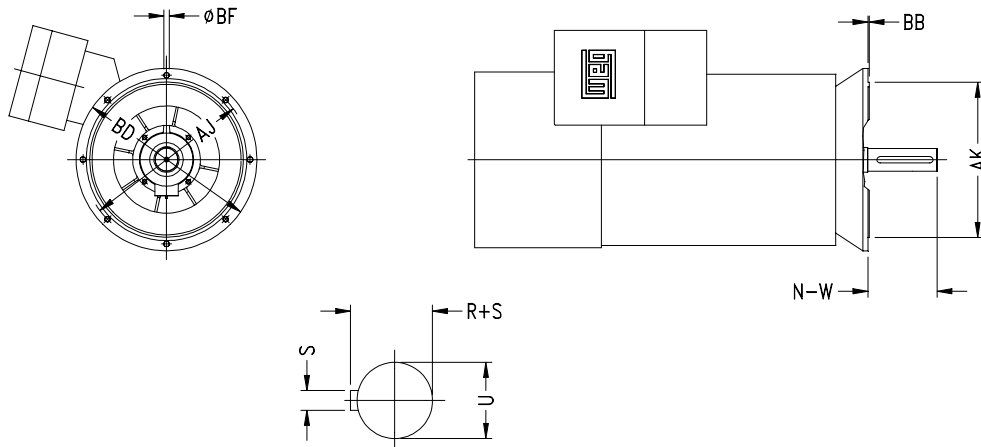

Distance between feet holes (front view).....A=
 Distance between feet holes (side view).....B=
 Distance between feet holes and shaft shoulder....C=

Shaft end diameter.....D=
 Shaft end length.....E=
 Shaft end height.....H=

PULLEY / BELT COUPLING

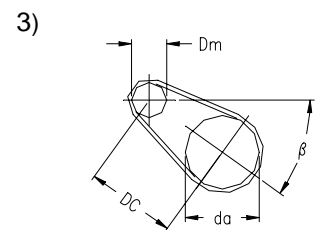
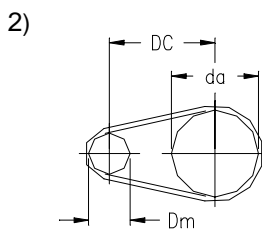
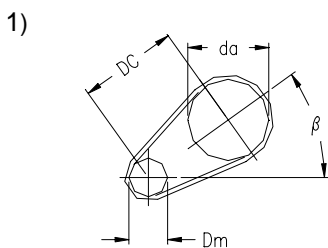

ADDITIONAL DATA TO BE INFORMED WHEN THE LOAD IS DRIVEN BY PULLEIS:

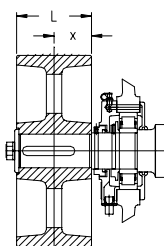

Output.....kW=
 Motor speed.....rpm=
 Sheave diameter.....=
 Sheave type and diameter.....=
 Diameter of drive pulley.....DM=
 Diameter of driven pulley.....da=
 Distance between centers.....DC=
 Pulley width.....L=
 Distance between belt center to shaft shoulder.....X=
 Which of the figures do correspond to the application?
 1 () 2 () 3 ()
 What is the value of the angle (β)?.....=



WEG EXPORTADORA

Av. Prof. Waldemar Grubba, 3000 89256-900 Jaraguá do Sul/SC
Phone: 55 (047) 372-4000 Fax: 55 (047) 372-4030
São Paulo/SP: Phone: 55 (011) 5053-2300 Fax: 55 (011) 5052-4202
www.weg.com.br